

OPERATING MANUAL
MASTERFLEX[®] L/S[®]

**AIR-POWERED
PUMP DRIVES**

**Model No.
7569-00**

Cole-Parmer Instrument Co.
625 East Bunker Ct.
Vernon Hills, Illinois U.S.A. 60061-1844
800-MASTERFLEX (627-8373)
(847) 247-2929 FAX
www.masterflex.com
e-mail: techinfo@coleparmer.com

A-1299-0105
Edition 07



WARNING: PRODUCT USE LIMITATION

This product is not designed for, nor intended for, use in patient-connected applications; including, but not limited to, medical and dental use, and, accordingly, has not been submitted for FDA approval.

EU Declaration of Conformity

Name of Apparatus: MASTERFLEX® Air-Powered L/S® Drive with Pump Head

Model Number: 77931-10

Description of Apparatus: Peristaltic Pump Motor Drive and Pump Head. Used to pump fluids.

Barnant Company declares that the above model is in conformity to the following harmonized standards and directives:

Applicable Directive	Applicable Specifications	Manufacturer's Report Number
89/392/EEC 91/368/EEC 93/44/EEC 93/68/EEC	EN 292-1: 1991 EN 292-2/A1: 1995	TR9525

Manufacturer:

Barnant Company Division
Cole-Parmer Instrument Company
28W092 Commercial Avenue
Barrington, IL 60010-2392
USA
Tel.: 847-381-7050

Manufacturer's Signature:

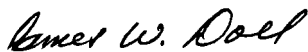

James W. Doll
Vice President, Engineering

25 August, 2000

Date

SETUP AND DRIVE OPERATION

INTRODUCTION AND GENERAL DESCRIPTION

This air-powered pump drive, when used with a MASTERFLEX® L/S® Pump Head, is an excellent variable-flow pump for hazardous-duty applications, when properly grounded, or when electrical power is not available.

VARIETY OF PUMP HEADS ACCEPTED

Mount up to 2 MASTERFLEX® L/S® Pump Heads and all MASTERFLEX® L/S®-compatible Pump Heads. See individual Pump Heads for flow rates.

SETUP AND DRIVE OPERATION

1. Unpack the drive. Save packing material until proper product operation has been verified.
2. Install pressure gauge, pressure regulator/lubricator/filter assembly (B, C) and muffler (D). See Figures 1 and 2 for proper orientation. (All items and fittings included.) Use thread seal for all connections to reduce the possibility of air leakage.
3. Connect compressed air line to 1/4 NPT(F) connection on regulator (or use adapter for 3/16 in ID hose provided).
4. Mount Pump Head and load tubing. (See Pump Head manual.)
5. Turn on compressed air line to start pumping (maximum: 150 psig [10.3 bar] inlet).
6. Adjust flow rate with the adjustment knob on top of the regulator. Vary flow rate from 1 to 25 psig (0.07 to 1.72 bar). (Lock flow rate by using snap-action push-pull knob.)

CAUTION: Ensure that pump speed does not exceed 600 rpm. Speeds higher than 600 rpm may damage pump.



7. For continuous-duty or high-speed applications, use of the lubricator is recommended. Adjust the lubricator with the adjustment knob on top. For higher speeds, set lubricator to provide 1 to 3 drops per minute. Use a lower setting for lower speeds. See MAINTENANCE for RECOMMENDED LUBRICANTS. (Lock lubrication rate by using snap-action push-pull knob.)

- A. Pump Head Mounting Holes
- B. Filter/Regulator Control Knob
- C. Lubricator Control Knob

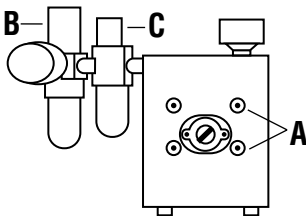

Fig. 1 Front view of drive

- D. Muffler
- E. Air Motor

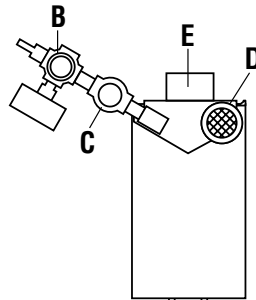

Fig. 2 Top view of drive

MAINTENANCE

The air motor is a rotary vane type motor. Lubrication is necessary for the bearings, shaft seals and rust prevention.

Excessive moisture in the air line can cause rust formation in the motor and can cause ice to form in the muffler due to expansion of air through the motor.

RECOMMENDED LUBRICANTS

Use a misting type oil rated 50 to 200 SSU (ISO Grade 7 to 46) at 100°F (38°C). Unscrew the bowl to fill the lubricator. Press up on the bottom drain to empty bowl.

CLEANING

Keep the drive enclosure clean with mild detergents. Never immerse nor use excessive fluid.

GEAR REPLACEMENT

A plastic intermediate gear protects the drive system from torque overloads. To replace gear (see Figure 3):

1. Disconnect from compressed air supply.
2. Remove housing.
3. Remove front mounting plate.
4. Replace gear or gear/shaft assembly. See REPLACEMENT PARTS AND ACCESSORIES.
5. Reassemble in reverse order.

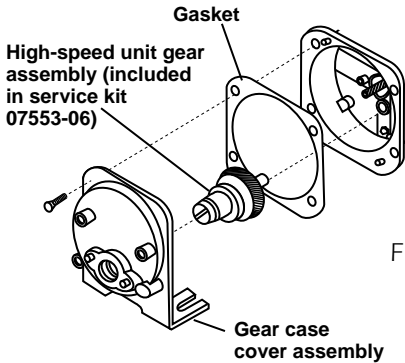

Fig. 3 Gear Replacement

DRAIN OPERATION

The filter/regulator assembly has a manual drain. Check it frequently for water accumulation. Open drain by pressing up on bottom of bowl.

TROUBLESHOOTING

If drive does not operate, disconnect power and

- a. Check pump head for tubing jam.
- b. Check air supply.
- c. Check drive gear for stripping.

Contact your dealer for further service needs.

REPLACEMENT PARTS AND ACCESSORIES

07553-06, Gear Service Kit, High-speed units

07553-09, Gear only, High-speed units

07055-50, Replacement air motor

SPECIFICATIONS

Output Speed:	60 to 600 rpm
Maximum Load:	180 oz•in (13 kg•cm)
Regulation:	± 15 rpm (60 to 150 rpm) ± 20 rpm (150 to 600 rpm)
Power Input:	10 cfm (0.28 m³/min) @ 150 psig (10.3 bar)
Power Output:	3/4 hp (560 W)
Operating Temperature:	32° to 104°F (0° to 40°C)
Storage Temperature:	14° to 149°F (-10° to 65°C)
Humidity (non-condensing):	10% to 90%
Chemical Resistance:	Exposed materials are painted CRS, brass, aluminum and plastic
Enclosure Rating:	NOT APPLICABLE
Altitude:	Less than 2000 m
Dimensions (L × W × H):	9-7/8 in × 4-13/16 in × 8-13/16 in (251 × 122 × 224 mm)
Weight:	14 lbs (6.35 kg)
Compliance (for CE Mark):	EN 292-1: 1991 and EN 292-2/A1: 1995 (EU Machine Directive)

WARRANTY

Use only MASTERFLEX precision tubing with MASTERFLEX pumps to ensure optimum performance. Use of other tubing may void applicable warranties.

The Manufacturer warrants this product to be free from significant deviations from published specifications. If repair or adjustment is necessary within the warranty period, the problem will be corrected at no charge if it is not due to misuse or abuse on your part, as determined by the Manufacturer. Repair costs outside the warranty period, or those resulting from product misuse or abuse, may be invoiced to you.

The warranty period for this product is noted on the Warranty Card.

PRODUCT RETURN

To limit charges and delays, contact the seller or Manufacturer for authorization and shipping instructions before returning the product, either within or outside of the warranty period. When returning the product, please state the reason for the return. For your protection, pack the product carefully and insure it against possible damage or loss. Any damages resulting from improper packaging are your responsibility.

TECHNICAL ASSISTANCE

If you have any questions about the use of this product, contact the Manufacturer or authorized seller.